

8-Ton Industrial Pulley Puller Parts

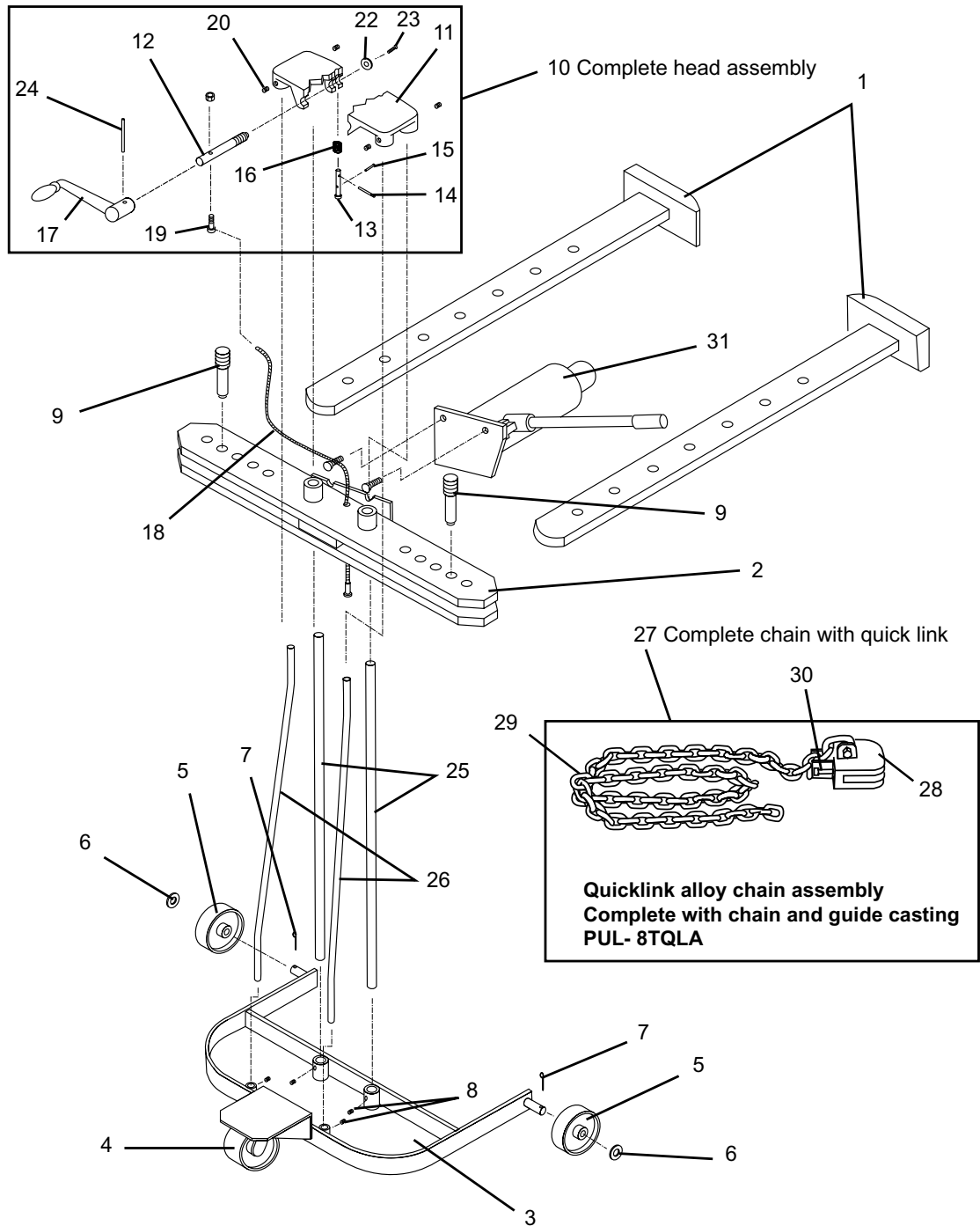

P.O. Box 626 • 3575 3rd Ave. • Marion, IA 52302 • Ph: 319.447.2245 • Fax: 319.377.1204
 e-mail: sales@pulleypuller.com • Home Page: www.pulleypuller.com

8 TON PULLEY PULLER REPLACEMENT PARTS LIST

Ref No.	PART NUMBER	DESCRIPTION
	PUL-8 TON-PP	PORTABLE HYDRAULIC PULLEY PULLER COMPLETE WITH QUICK-LINK CHAIN ATTACHMENT
1	PUL-8TA	8-TON PULLER ARM ASSEMBLY
2	PUL-8TB	8-TON PULLER BEAM ASSEMBLY
3	PUL-8TC	8-TON CARRIAGE BASE ASSEMBLY
4	PUL-8TC-08	CASTER; SWIVEL #50-A-2
5	PUL-8TC-09	CASTER; STATIONARY #25-2050 PBSE-1-8
6	PUL-8TC-10	AXLE WHEEL WASHER; 8-TON
7	PUL-8TC-11	AXLE WHEEL COTTER PIN; 8-TON
8	PUL-20TH-12	SET SCREW; 5/16" x 3/8"
9	PUL-8 TON PIN	BEAM PIN 20-TON
10	PUL-8TH	8-TON PULLER HEAD ASSEMBLY (COMPLETE)
11	PUL-8TH-1	CASTING (ONLY)
12	PUL-8TH-3	8-TON; RATCHET SHAFT
13	PUL-8TH-5	8 TON; PAWL
14	PUL-8/20TH-6	SPRING PIN; 3/16"Dia. x 2"
15	PUL-8TH-7	PH MACHINE SCREW; 8-32 x 3/4"
16	PUL-8/20TH-8	SPRING; 8-TON
17	PUL-8/20TH-9	HANDLE; MACHINED, 8-TON
18	PUL-8/20TH-10	CABLE ASSEMBLY; 5/32" 8-TON
19	PUL-8TH-11	8-TON BOLT/LOCKNUT ASSEMBLY
20	PUL-20TH-12	SET SCREW; 5/16" x 3/8"
21	PUL-8/20TH-13	SPRING PIN; 3/16" DIA. x 1-1/2"
22	PUL-8TH-17	FENDER WASHER; 1/4" ID x1-1/4" OD
23	PUL-8TH-18	BH CAP SCREW; 1/4"-20 x 1/2"
24	PUL-8TH-19	SPRING PIN; 3/16"Dia. x1-1/2"
25	PUL-8TU-1	UPRIGHT SUPPORT ROD; 8-TON
26	PUL-8TU-2	UPRIGHT BRACE ROD; 8-TON
27	PUL-8TQLA	QUICK-LINK CHAIN ASSY; 20 TON (COMPLETE WITH QUICK LINK)
28	PUL-8TQ-1	8-TON MACHINED QUICK LINK (ONLY)
29	PUL-8TQLC	CHAIN (ONLY); 3/8" x 4'-0" LONG (8-TON)
30	73-1600	SQUARE HEAD SETSCREW: 3/8"X 2-1/2"
31	PUL-8TR-3	JH-8; HYDRAULIC JACK